



**Dear Customers,**

the window is a centre of attraction in every house, the part of the apartment that connects us with the outside world. This architectural detail is particularly important for the overall look of facades and also within the houses for the impression of the given room of shape and design.

By using different types of wood for the window frame and the use of glass, fittings and paint, individual windows can be produced for every customer request.

An important part of production is the use of materials made from natural resources and biological and ecological products that are sustainable and renewable.

Our claim for high quality and the use of the latest production technologies ensure that the wooden windows and doors will be used for many years.

Take a look at our range of products and choose the products that suit your needs and tastes.

If you have special requests, we are always able to meet them, because your house, your apartment, should look the way you wanted it to.

We welcome you to our world of windows and doors.







**Detail view of a window axis from the Berlin Palace opposite the Berlin Cathedral.**

Here you can see half a window axis in a ratio of 1:1. This detail is just a section of 0.5 % of the entire palace surface.

The Berlin Palace, also known as the Berlin City Palace since the 19th century, was the central building in the centre of Berlin.

Built as a residential palace in 1442 by order of the margraves and electors of Brandenburg on the Spree island in Alt-Cölln, after extensions from 1702 onwards, the palace became a royal and ultimately an imperial residence in Prussia and it is now being rebuilt at its old location as the central building for culture and science in the new Berlin.





Wood has been used by humans in a variety of ways for thousands of years. It is a perfect substance of nature, has unusual properties, releases energy and speaks to us through its natural beauty in every form, every kind and every way.

**Windows and doors** made of wood speak for themselves because of their durability and original quality. We offer our windows in the following types of wood, among others: pine, oak and meranti.

**Pine wood** is the most commonly used type of wood for the manufacture of windows. It is characterized by high durability, bright and fresh colors, easy processing and design and high resilience. It is a wood with good technical strength and is recommended by us for customers who value traditional solutions and economical operation.

The wood species **Meranti** is an exotic wood and has been used in Europe for several years in craft as well as industry. Meranti is a deciduous tree from Indonesia. It is known for its extraordinary resistance against moisture, due to the oil content and is therefore particularly suitable for outdoor use.

Meranti is durable and robust. It has a characteristic porous structure that presents its structure very impressively with its transparent color. Meranti is popular in areas with high humidity.





The wood species **oak** is the best wood species in our native deciduous trees. It is better than pine and larch. Oak wood is hard, very durable and resistant to abrasion. It is characterized by high durability and resistance to changing humidity conditions.

**Window squared timber** is glued in three or four layers of wood. Applying the highest EU standards.

Our suppliers work with the most modern production technologies and ensure high product quality. The use of **IFT Rosenheim - and FSC-certified** wood ensures the supply of raw materials with responsible forest management.







## PRODUCT DETAILS:

<b>Construction:</b>	<ul style="list-style-type: none"> <li>- single-frame construction,</li> <li>- frame thickness 68mm,</li> <li>- three-layer glued scantlings,</li> <li>- different widths of profiles for the frame and sash.</li> <li>- with lamellas joined along their length or with external solid lamellas.</li> </ul>
<b>Material:</b>	pine, spruce, larch, meranti, oak.
<b>Acoustic insulation:</b>	$R_w = 31 - 39\text{dB}$ (depending on the selected glazing unit).
<b>Thermal transmittance:</b>	$U_w: 1,30 - 1,42\text{ W/m}^2\text{K}$ .
<b>Glazing:</b>	<ul style="list-style-type: none"> <li>- 2-glass package, single-chamber 4/16/4; glazing thermal insulation: <math>U_g = 1.1\text{ W/m}^2\text{K}</math> (argonfilled inter-pane space),</li> <li>- triple glazing (4/12/4/12/4) is not possible with the wood profile IV68, only with the wood-aluminium profile,</li> <li>- the use of standard aluminium spacers,</li> <li>- optional: warm edge in the colour of the frames (spacer manufacturers: TGI, SWISSPACER or CHROMATECH; useful for every window colour).</li> </ul>
<b>Fittings:</b>	<ul style="list-style-type: none"> <li>- envelope WinkHaus Activpilot, with one anti-burglary mushroom in the sash,</li> <li>- optionally: the possibility of using fittings with an increased security class: RC1 or RC2 with antipry bolts in door leaf, handle rotation locks with a lift, window opening limiter, gradual tilting, balcony latch),</li> <li>- with the possible application of the Winkhaus Activpilot Select envelope fittings (hidden).</li> </ul>
<b>Way of opening:</b>	turn windows (R), tilt windows (U), turn-tilt windows (RU), fixed.
<b>Colour:</b>	<ul style="list-style-type: none"> <li>- covering from the RAL palette or azure (showing the structure of the wood) from the catalog of transparent standard colours,</li> <li>- three-layer system / covering colour / impregnation, priming, surface); four-coat system (azure colour / impregnation, priming, interlayer, surface),</li> <li>- optional: two-colour RAL / azure, azure / RAL.</li> </ul>
<b>Gaskets:</b>	<ul style="list-style-type: none"> <li>- 2,</li> <li>- optional: 3.</li> </ul>
<b>The drip:</b>	<ul style="list-style-type: none"> <li>- aluminium in standard colours: white, silver, brown or dark brown,</li> <li>- optionally: aluminium in a selected RAL colour matching the colour of the window,</li> <li>- optionally: wooden drip or with a wooden cover.</li> </ul>
<b>Silicone:</b>	<ul style="list-style-type: none"> <li>- transparent colour,</li> <li>- optionally: silicone colour matched to the colour of the wood,</li> <li>- available colours: white, cream-white, gray-white, transparent-gray, light-gray, gray, silver-gray, concrete-gray, jasmine, light oak, dark.</li> </ul>
<b>Handles:</b>	<ul style="list-style-type: none"> <li>- Hoppe Luxembourg as standard - in white, old gold, silver or brown,</li> <li>- optional: other handles with a key or a button from the Hoppe, FSB or FKS catalogue.</li> </ul>
<b>Warranty:</b>	5 years.

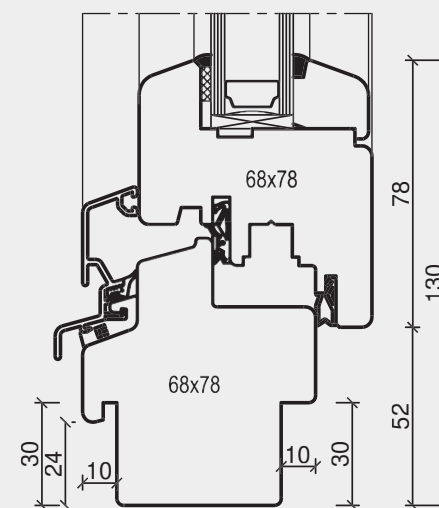
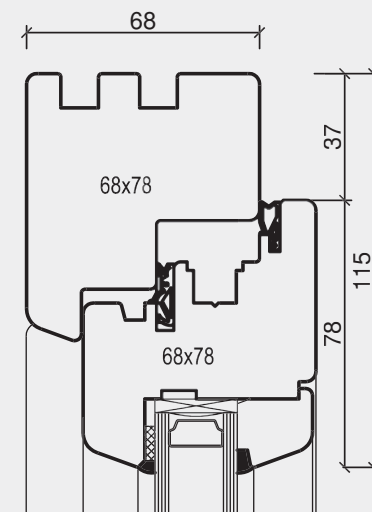







## PRODUKTDDETAILS:

<b>Construction:</b>	<ul style="list-style-type: none"> <li>- single-frame construction,</li> <li>- frame thickness 68mm,</li> <li>- three-layer glued scantlings,</li> <li>- different widths of profiles for the frame and sash.</li> <li>- with lamellas joined along their length or with external solid lamellas.</li> </ul>
<b>Material:</b>	pine, spruce, larch, meranti, oak.
<b>Acoustic insulation:</b>	$R_w = 31 - 39\text{dB}$ (depending on the selected glazing unit).
<b>Thermal transmittance:</b>	$U_w: 1,30 - 1,42\text{ W/m}^2\text{K}$ .
<b>Glazing:</b>	<ul style="list-style-type: none"> <li>- 2-glass package, single-chamber 4/16/4; glazing thermal insulation: <math>U_g = 1.1\text{ W/m}^2\text{K}</math> (argonfilled inter-pane space),</li> <li>- triple glazing (4/12/4/12/4) is not possible with the wood profile IV68, only with the wood-aluminium profile,</li> <li>- the use of standard aluminium spacers,</li> <li>- optional: warm edge in the colour of the frames (spacer manufacturers: TGI, SWISSPACER or CHROMATECH; useful for every window colour).</li> </ul>
<b>Fittings:</b>	<ul style="list-style-type: none"> <li>- envelope WinkHaus Activpilot, with one anti-burglary mushroom in the sash,</li> <li>- optionally: the possibility of using fittings with an increased security class: RC1 or RC2 with antipry bolts in door leaf, handle rotation locks with a lift, window opening limiter, gradual tilting, balcony latch),</li> <li>- with the possible application of the Winkhaus Activpilot Select envelope fittings (hidden).</li> </ul>
<b>Way of opening:</b>	turn windows (R), tilt windows (U), turn-tilt windows (RU), fixed.
<b>Gaskets:</b>	<ul style="list-style-type: none"> <li>- 2,</li> <li>- optional: 3.</li> </ul>
<b>Colour:</b>	<ul style="list-style-type: none"> <li>- covering from the RAL palette or azure (showing the structure of the wood) from the catalog of transparent standard colours,</li> <li>- three-layer system / covering colour / impregnation, priming, surface); four-coat system (azure colour / impregnation, priming, interlayer, surface),</li> <li>- optional: two-colour RAL / azure, azure / RAL.</li> </ul>
<b>The drip:</b>	<ul style="list-style-type: none"> <li>- aluminium in standard colours: white, silver, brown or dark brown,</li> <li>- optionally: aluminium in a selected RAL colour matching the colour of the window,</li> <li>- optionally: wooden drip or with a wooden cover.</li> </ul>
<b>Silicone:</b>	<ul style="list-style-type: none"> <li>- transparent colour,</li> <li>- optionally: silicone colour matched to the colour of the wood,</li> <li>- available colours: white, cream-white, gray-white, transparent-gray, light-gray, gray, silver-gray, concrete-gray, jasmine, light oak, dark.</li> </ul>
<b>Handles:</b>	<ul style="list-style-type: none"> <li>- Hoppe Luxembourg as standard - in white, old gold, silver or brown,</li> <li>- optional: other handles with a key or a button from the Hoppe, FSB or FKS catalogue.</li> </ul>
<b>Warranty:</b>	5 years.

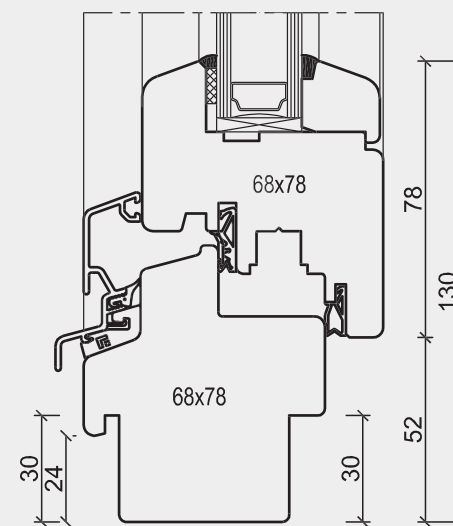
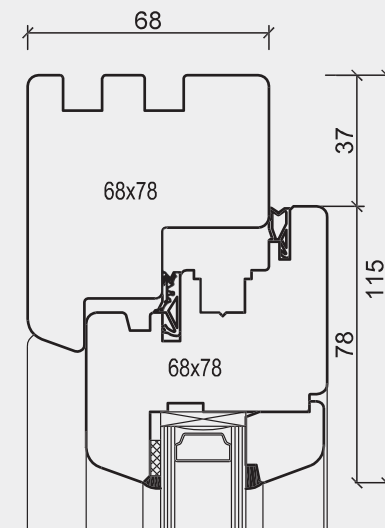







## PRODUKTDDETAILS:

<b>Construction:</b>	<ul style="list-style-type: none"> <li>- single-frame construction,</li> <li>- decorative ornaments on the frame and sash on the outside and on the inside; bars are inside without milling,</li> <li>- frame thickness 68mm,</li> <li>- three-layer glued scantlings,</li> <li>- different widths of profiles for the frame and sash,</li> <li>- with lamellas joined along their length or with external solid lamellas.</li> </ul>
<b>Material:</b>	pine, spruce, larch, meranti, oak.
<b>Acoustic insulation:</b>	$R_w = 31 - 39\text{dB}$ (depending on the selected glazing unit).
<b>Thermal transmittance:</b>	$U_w: 1,30 - 1,42 \text{ W/m}^2\text{K}$ .
<b>Glazing:</b>	<ul style="list-style-type: none"> <li>- 2-glass package, single-chamber 4/16/4; glazing thermal insulation: <math>U_g = 1.1 \text{ W / m}^2\text{K}</math> (argonfilled inter-pane space),</li> <li>- triple glazing (4/12/4/12/4) is not possible with the wood profile IV68, only with the wood-aluminium profile,</li> <li>- the use of standard aluminium spacers,</li> <li>- optional: warm edge in the colour of the frames (spacer manufacturers: TGI, SWISSPACER or CHROMATECH; useful for every window colour).</li> </ul>
<b>Fittings:</b>	<ul style="list-style-type: none"> <li>- envelope WinkHaus Activpilot, with one anti-burglary mushroom in the sash,</li> <li>- optionally: the possibility of using fittings with an increased security class: RC1 or RC2 with antipry bolts in door leaf, handle rotation locks with a lift, window opening limiter, gradual tilting, balcony latch),</li> <li>- with the possible application of the Winkhaus Activpilot Select envelope fittings (hidden).</li> </ul>
<b>Way of opening:</b>	turn windows (R), tilt windows (U), turn-tilt windows (RU), fixed.
<b>Gaskets:</b>	<ul style="list-style-type: none"> <li>- 2,</li> <li>- optional: 3.</li> </ul>
<b>Colour:</b>	<ul style="list-style-type: none"> <li>- covering from the RAL palette or azure (showing the structure of the wood) from the catalog of transparent standard colours,</li> <li>- Three-layer system / covering colour / impregnation, priming, surface); four-coat system (azure colour / impregnation, priming, interlayer, surface),</li> <li>- optional: two-colour RAL / azure, azure / RAL.</li> </ul>
<b>The drip:</b>	<ul style="list-style-type: none"> <li>- aluminium in standard colours: white, silver, brown or dark brown,</li> <li>- optionally: aluminium in a selected RAL colour matching the colour of the window,</li> <li>- optionally: wooden drip or with a wooden cover.</li> </ul>
<b>Silicone:</b>	<ul style="list-style-type: none"> <li>- transparent colour,</li> <li>- optionally: silicone colour matched to the colour of the wood,</li> <li>- available colours: white, cream-white, gray-white, transparent-gray, light-gray, gray, silver-gray, concrete-gray, jasmine, light oak, dark.</li> </ul>
<b>Handles:</b>	<ul style="list-style-type: none"> <li>- Hoppe Luxembourg as standard - in white, old gold, silver or brown,</li> <li>- optional: other handles with a key or a button from the Hoppe, FSB or FKS catalogue.</li> </ul>
<b>Warranty:</b>	5 years.

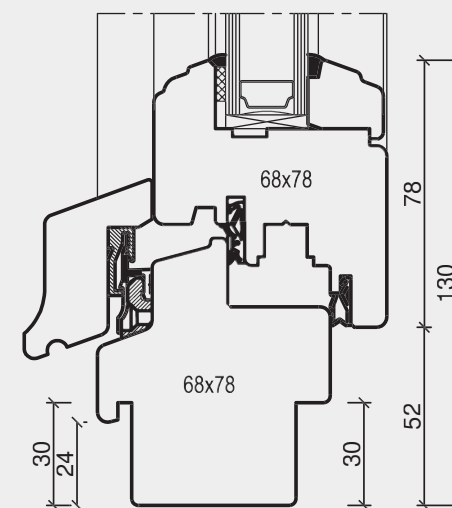
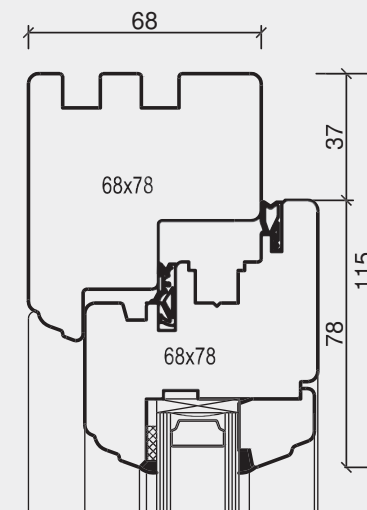







## PRODUKTDDETAILS:

<b>Construction:</b>	<ul style="list-style-type: none"> <li>- single-frame construction,</li> <li>- frame thickness 68mm,</li> <li>- three-layer glued scantlings,</li> <li>- different widths of profiles for the frame and sash.</li> <li>- with lamellas joined along their length or with external solid lamellas.</li> </ul>
<b>Material:</b>	pine, spruce, larch, meranti, oak.
<b>Acoustic insulation:</b>	$R_w = 31 - 39\text{dB}$ (depending on the selected glazing unit).
<b>Thermal transmittance:</b>	$U_w: 1,30 - 1,42\text{ W/m}^2\text{K}$ .
<b>Glazing:</b>	<ul style="list-style-type: none"> <li>- 2-glass package, single-chamber 4/16/4; glazing thermal insulation: <math>U_g = 1.1\text{ W/m}^2\text{K}</math> (argonfilled inter-pane space),</li> <li>- triple glazing (4/12/4/12/4) is not possible with the wood profile IV68, only with the wood-aluminium profile,</li> <li>- the use of standard aluminium spacers,</li> <li>- optional: warm edge in the colour of the frames (spacer manufacturers: TGI, SWISSPACER or CHROMATECH; useful for every window colour).</li> </ul>
<b>Fittings:</b>	<ul style="list-style-type: none"> <li>- envelope WinkHaus Activpilot, with one anti-burglary mushroom in the sash,</li> <li>- optionally: the possibility of using fittings with an increased security class: RC1 or RC2 with antipry bolts in door leaf, handle rotation locks with a lift, window opening limiter, gradual tilting, balcony latch),</li> <li>- with the possible application of the Winkhaus Activpilot Select envelope fittings (hidden).</li> </ul>
<b>Way of opening:</b>	turn windows (R), tilt windows (U), turn-tilt windows (RU), fixed.
<b>Gaskets:</b>	<ul style="list-style-type: none"> <li>- 2,</li> <li>- optional: 3.</li> </ul>
<b>Colour:</b>	<ul style="list-style-type: none"> <li>- covering from the RAL palette or azure (showing the structure of the wood) from the catalog of transparent standard colours,</li> <li>- Three-layer system / covering colour / impregnation, priming, surface); four-coat system (azure colour / impregnation, priming, interlayer, surface),</li> <li>- optional: two-colour RAL / azure, azure / RAL.</li> </ul>
<b>The drip:</b>	<ul style="list-style-type: none"> <li>- aluminium in standard colours: white, silver, brown or dark brown,</li> <li>- optionally: aluminium in a selected RAL colour matching the colour of the window,</li> <li>- optionally: wooden drip or with a wooden cover.</li> </ul>
<b>Silicone:</b>	<ul style="list-style-type: none"> <li>- transparent colour,</li> <li>- optionally: silicone colour matched to the colour of the wood, available colours: white, cream-white, gray-white, transparent-gray, light-gray, gray, silver-gray, concrete-gray, jasmine, light oak, dark.</li> </ul>
<b>Handles:</b>	<ul style="list-style-type: none"> <li>- Hoppe Luxembourg as standard - in white, old gold, silver or brown,</li> <li>- optional: other handles with a key or a button from the Hoppe, FSB or FKS catalogue.</li> </ul>
<b>Warranty:</b>	5 years.

### F78/S78

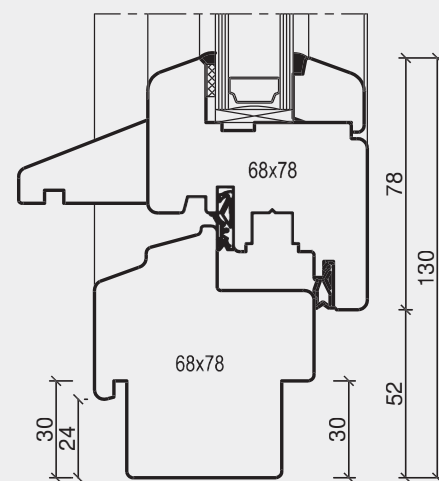
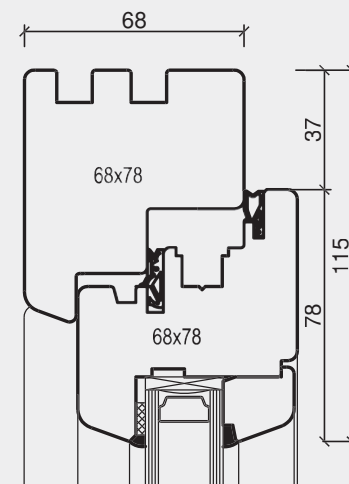

### F78/S65

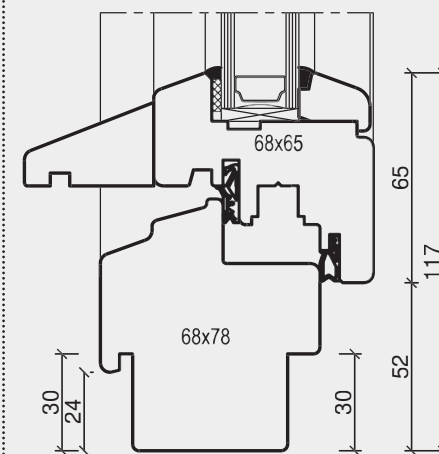
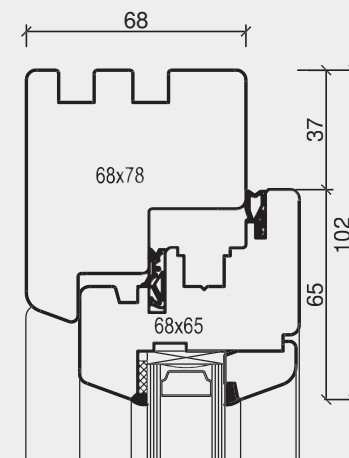



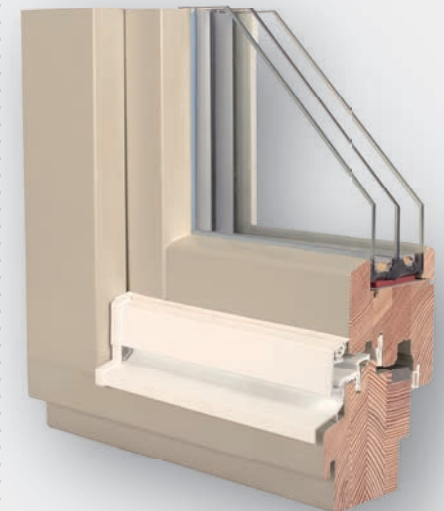
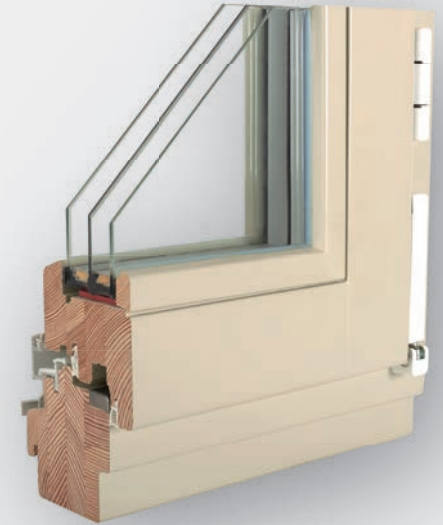



## PRODUCT DETAILS:

<b>Construction:</b>	<ul style="list-style-type: none"> <li>- single-frame structure,</li> <li>- 78 mm thick frame,</li> <li>- four-layer glued square timber,</li> <li>- with lamellas joined along their length or with external solid lamellas,</li> <li>- different widths of profiles for the frame and sash.</li> </ul>
<b>Material:</b>	pine, spruce, larch, meranti, oak.
<b>Acoustic insulation:</b>	$R_w = 32 - 39\text{dB}$ (depending on the selected glazing unit).
<b>Thermal transmittance:</b>	$U_w: 1,20 - 0,97\text{ W/m}^2\text{ K}$ .
<b>Glazing:</b>	<ul style="list-style-type: none"> <li>- standard 3-glass package, two-chamber 4/12/4/12/4, glazing thermal insulation up to <math>U_g=0,7\text{ W/ m}^2\text{K}</math> (argon-filled inter-pane space),</li> <li>- max. glazing-set: up to 44 mm,</li> <li>- the use of standard aluminium spacers,</li> <li>- optional: warm edge in the colour of the frames (spacer manufacturers: TGI, SWISSPACER or CHROMATECH; useful for every window colour).</li> </ul>
<b>Fittings:</b>	<ul style="list-style-type: none"> <li>- envelope WinkHaus Activpilot, with one anti-burglary mushroom in the sash,</li> <li>- optionally: the possibility of using fittings with an increased security class: RC1 or RC2 with antipry bolts in door leaf, handle rotation locks with a lift, window opening limiter, gradual tilting, balcony latch); with the possible application of the Winkhaus Activpilot Select envelope fittings (hidden),</li> <li>- with the possible application of the Winkhaus Activpilot Select envelope fittings (hidden).</li> </ul>
<b>Way of opening:</b>	turn windows (R), tilt windows (U), turn-tilt windows (RU), fixed.
<b>Colour:</b>	<ul style="list-style-type: none"> <li>- covering from the RAL palette or azure (showing the structure of the wood) from the catalog of transparent standard colours,</li> <li>- Three-layer system / covering colour / impregnation, priming, surface); four-coat system (azure colour / impregnation, priming, interlayer, surface),</li> <li>- optional: two-colour RAL / azure, azure / RAL.</li> </ul>
<b>Gaskets:</b>	<ul style="list-style-type: none"> <li>- 2,</li> <li>- optional 3.</li> </ul>
<b>The drip:</b>	<ul style="list-style-type: none"> <li>- aluminium in standard colours: white, silver, brown or dark brown,</li> <li>- optionally: aluminium in a selected RAL colour matching the colour of the window,</li> <li>- optionally: wooden drip or with a wooden cover.</li> </ul>
<b>Silicone:</b>	<ul style="list-style-type: none"> <li>- transparent colour,</li> <li>- optionally: silicone colour matched to the colour of the wood,</li> <li>- available colours: white, cream-white, gray-white, transparent-gray, light-gray, gray, silver-gray, concrete-gray, jasmine, light oak, dark oak, pine brown, ochre brown, medium brown, roe brown, chocolate brown, dark brown, black.</li> </ul>
<b>Handles:</b>	<ul style="list-style-type: none"> <li>- Hoppe Luxembourg as standard - in white, old gold, silver or brown,</li> <li>- optional: other handles with a key or a button from the Hoppe, FSB or FKS catalogue.</li> </ul>
<b>Warranty:</b>	5 years.

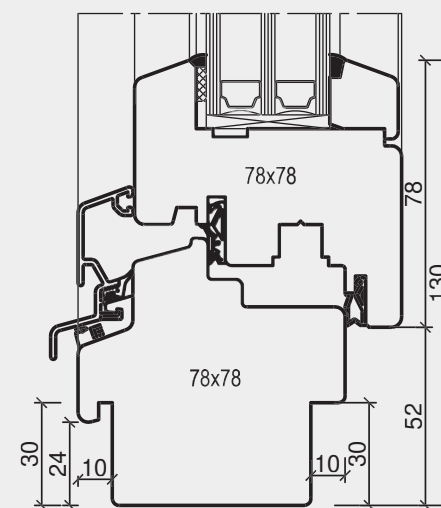
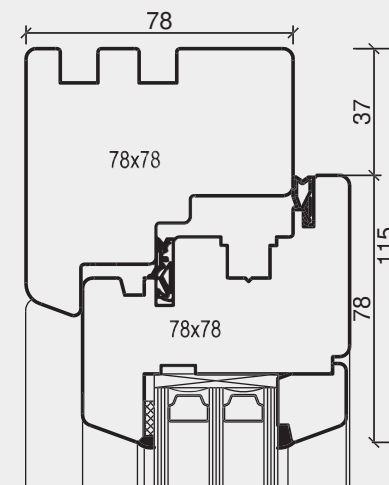



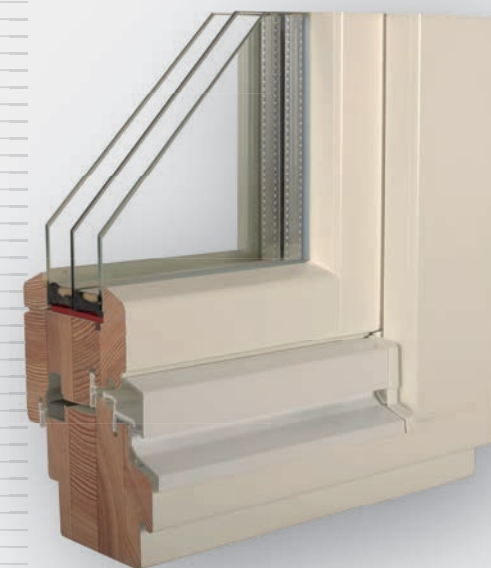
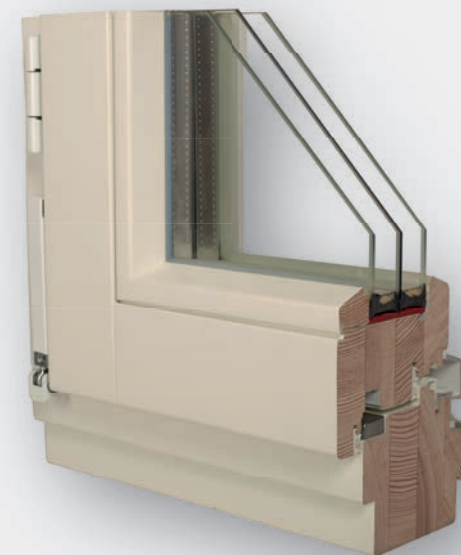



## PRODUCT DETAILS:

<b>Construction:</b>	<ul style="list-style-type: none"> <li>- Softline profile, single-frame construction,</li> <li>- massive 92mm thick frame,</li> <li>- four-layer glued scantlings (joined along the length),</li> <li>- with lamellas joined along their length or with external solid lamellas,</li> <li>- different widths of profiles for the frame and sash.</li> </ul>
<b>Material:</b>	pine, spruce, larch, meranti, oak.
<b>Acoustic insulation:</b>	Rw = 32 – 39dB (depending on the selected glazing unit).
<b>Thermal transmittance:</b>	Uw: 0,95 – 0,79 W/m2 K.
<b>Glazing:</b>	<ul style="list-style-type: none"> <li>- standard 3-glass package, two-chamber 4/18/4/18/4, glazing thermal insulation: <math>U_g = 1.1 \text{ W/m}^2\text{K}</math> up to <math>U_g = 0.5 \text{ W/m}^2</math> ((argon-filled inter-pane space),</li> <li>- max. glazing-set: up to 60 mm,</li> <li>- the use of standard aluminium spacers,</li> <li>- optional: warm edge in the colour of the frames ((spacer manufacturers: TGI, SWISSPACER or CHROMATECH; useful for every window colour).</li> </ul>
<b>Fittings:</b>	<ul style="list-style-type: none"> <li>- envelope WinkHaus Activpilot, with one anti-burglary mushroom in the sash,</li> <li>- optionally: the possibility of using fittings with an increased security class: RC1 or RC2 with antipry bolts in door leaf, handle rotation locks with a lift, window opening limiter, gradual tilting, balcony latch),</li> <li>- with the possible application of the Winkhaus Activpilot Select envelope fittings (hidden).</li> </ul>
<b>Way of opening:</b>	turn windows (R), tilt windows (U), turn-tilt windows (RU), fixed.
<b>Colour:</b>	<ul style="list-style-type: none"> <li>- covering from the RAL palette or azure (showing the structure of the wood) from the catalog of transparent standard colours,</li> <li>- Three-layer system / covering colour / impregnation, priming, surface); four-coat system (azure colour / impregnation, priming, interlayer, surface),</li> <li>- optional: two-colour RAL / azure, azure / RAL.</li> </ul>
<b>Gaskets:</b>	<ul style="list-style-type: none"> <li>- 2,</li> <li>- optional 3.</li> </ul>
<b>The drip:</b>	<ul style="list-style-type: none"> <li>- aluminium in standard colours: white, silver, brown or dark brown,</li> <li>- optionally: aluminium in a selected RAL colour matching the colour of the window,</li> <li>- optionally: wooden drip or with a wooden cover.</li> </ul>
<b>Silicone:</b>	<ul style="list-style-type: none"> <li>- transparent colour,</li> <li>- optionally: silicone colour matched to the colour of the wood,</li> <li>- available colours: white, cream-white, gray-white, transparent-gray, light-gray, gray, silver-gray, concrete-gray, jasmine, light oak, dark oak, pine brown, ochre brown, medium brown, roe brown, chocolate brown, dark brown, black.</li> </ul>
<b>Handles:</b>	<ul style="list-style-type: none"> <li>- Hoppe Luxembourg as standard - in white, old gold, silver or brown,</li> <li>- optional: other handles with a key or a button from the Hoppe, FKS or FSB catalogue.</li> </ul>
<b>Warranty:</b>	5 years.

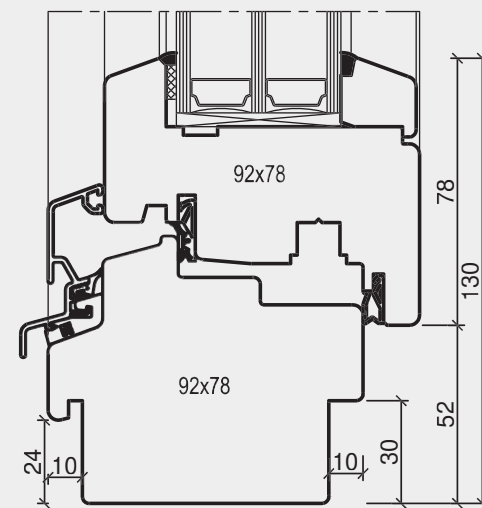
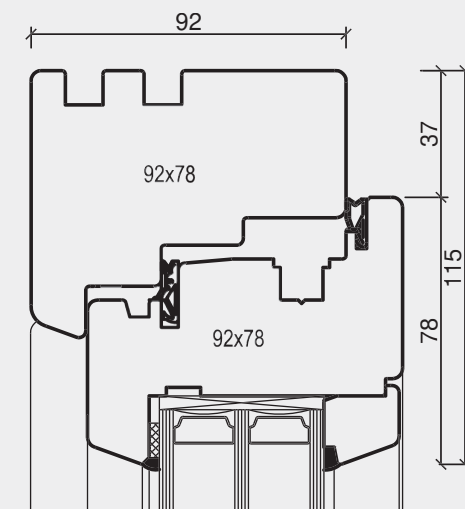





**WOOD-ALUMINIUM WINDOWS** - this is a brilliant combination of “warm” wood and aluminium. This system gives the windows good thermal performance. The windows look extremely interesting and are very safe.

Inside you have elegant, timeless wood, but outside you have a modern and durable construction made of aluminium. We offer different profiles from which you can choose.



## PRODUCT DETAILS:

<b>Construction:</b>	<ul style="list-style-type: none"> <li>- profiles: Gemini Classic, Gemini Softline, Gemini Linear, Gemini Retro, Gemini Quadrat, Gemini Quadrat FB, Gemini Integral, Gemini Passiv,</li> <li>- Thickness of the frame and sash: 68, 78 or 92mm + aluminium cap from the outside (aluminium producers: ALURON or GUTMANN).</li> </ul>
<b>Material:</b>	pine, spruce, larch, meranti, oak + aluminium.
<b>Acoustic insulation:</b>	Rw=32-42dB (depending on the selected glazing unit).
<b>Thermal transmittance:</b>	Uw = 1,40 – 0,80 W/m2K.
<b>Glazing:</b>	<ul style="list-style-type: none"> <li>- 2-glass or 3-glass isoglazing, e.g. two-chamber 4/12/4/12/4 (argon-filled inter-pane space, glazing thermal insulation Ug=0,7 W/m2K (36mm)) or 3-glass package 4/18/4/18/4 (two-chamber glazing, argonfilled, glazing thermal insulation: Ug from 0,5 W/m2K (48mm)),</li> <li>- max. glazing-set up to 60mm,</li> <li>- optional: warm edge in the colour of the frames (spacer manufacturers: TGI, SWISSPACER or CHROMATECH; useful for every window colour).</li> </ul>
<b>Fittings:</b>	<ul style="list-style-type: none"> <li>- locking system WinkHaus Activpilot, with an anti-burglary mushroom in the sash,</li> <li>- optionally: the possibility of using fittings with an increased security class: RC1 or RC2 with antipry bolts in door leaf, handle rotation locks with a lift, window opening limiter, gradual tilting, balcony latch),</li> <li>- optional applications of the Winkhaus Activpilot TopStar envelope hardware (hidden).</li> </ul>
<b>Way of opening:</b>	turn windows (R), tilt windows (U), turn-tilt windows (RU), fixed.
<b>Colour:</b>	<ul style="list-style-type: none"> <li>- aluminium color selected from among the color samples on aluminium,</li> <li>- wood color: opaque from the RAL palette or azure (showing the wood structure) from the catalog of transparent standard colours,</li> <li>- three-coat system (opaque color / impregnation, priming, surface); four-coat system (azure color / impregnation, priming, interlayer, surface).</li> </ul>
<b>Silicone:</b>	<ul style="list-style-type: none"> <li>- transparent colour,</li> <li>- optionally: silicone colour matched to the colour of the wood,</li> <li>- available colours: white, cream-white, gray-white, transparent-gray, light-gray, gray, silver-gray, concrete-gray, jasmine, light oak, dark oak, pine brown, ochre brown, medium brown, roe brown, chocolate brown, dark brown, black.</li> </ul>
<b>Handles:</b>	<ul style="list-style-type: none"> <li>- Hoppe Luxembourg as standard - in white, old gold, silver or brown,</li> <li>- optional: other handles with a key or a button from the Hoppe, FSB or FKS catalogue.</li> </ul>
<b>Warranty:</b>	5 years.

## TECHNICAL SOLUTIONS – EXAMPLES:

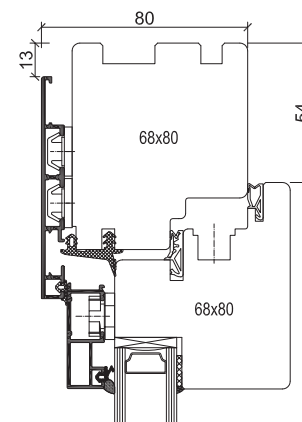

**Gemini Quadrat IV 68**

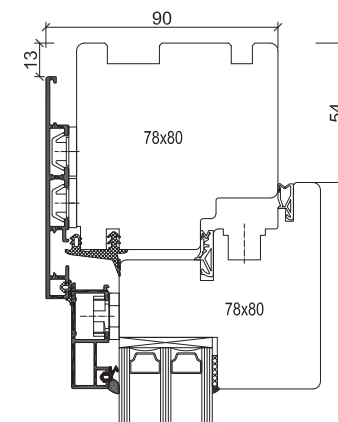

**Gemini Quadrat IV 78**

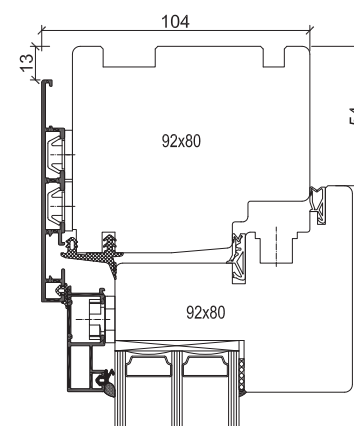

**Gemini Quadrat IV 92**

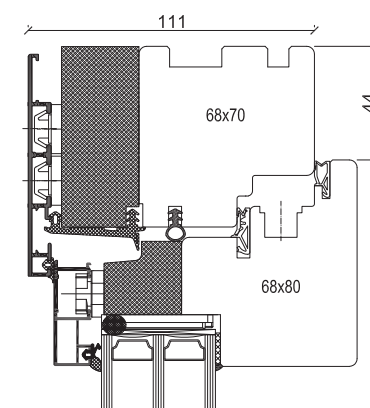

**Gemini Passiv IV 68**



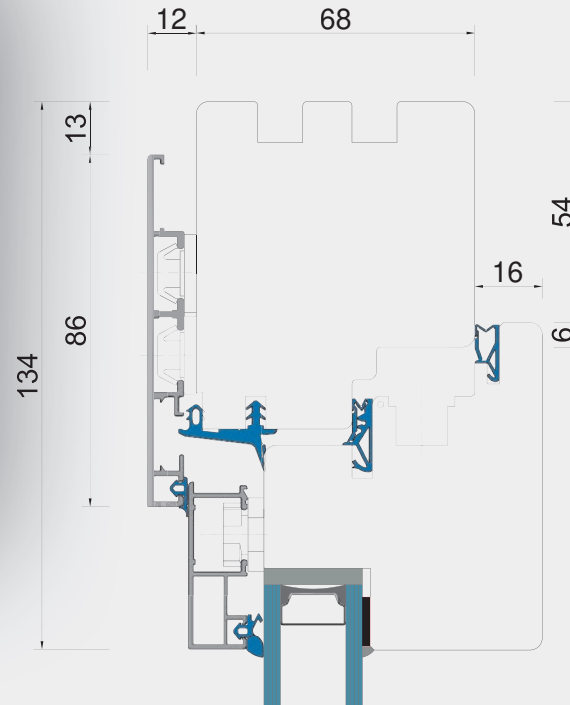
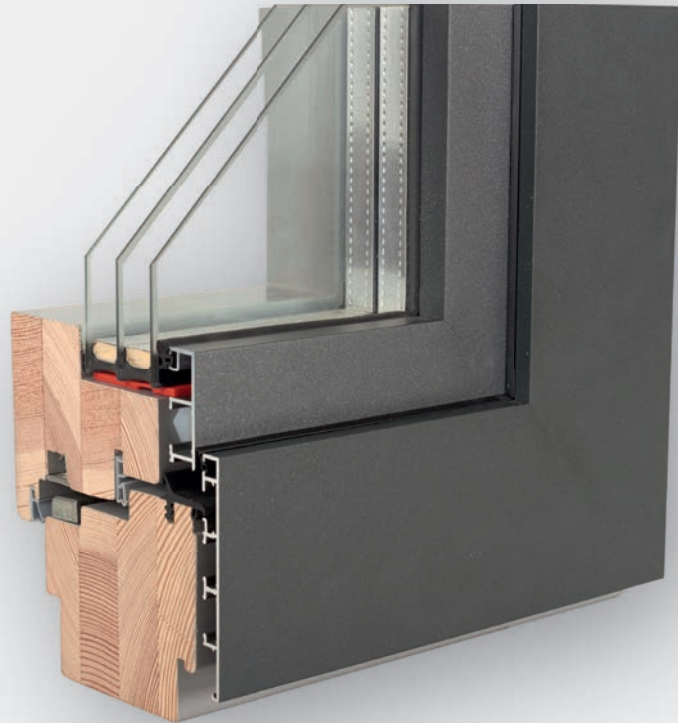

### Gemini Linear

is a system where the sash surface is flushed with the frame. The GEMINI Linear creates a clear angle on the surface. It is characterised by above-average functionality and utility. Gemini Linear is suitable for flushed and modern designs that blend in well with the concept of the building. Application: windows, doors, facade elements and winter gardens.

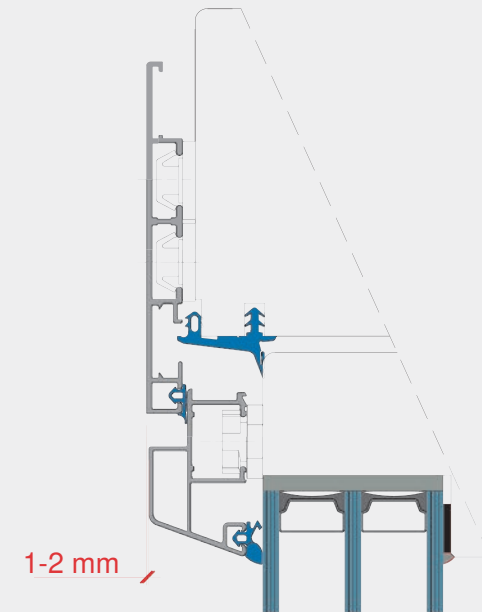

### Gemini Quadrat

The Gemini Quadrat systems have distinctive profile edges, with the sash shifted away from the frame and thus creating two distinct surfaces. The Quadrat is distinguished by its minimalistic and geometrical design, crucial in modern architecture where glass, concrete, aluminium and steel is the standard. Its uniqueness is further magnified by the lack of a visible slant, resulting in a right angle visible on the surface of Quadrat profiles.



### Gemini Classic

is a system for those who value tradition. Popular among our clients, Gemini Classic is an unflushed wood-alu system and it stands out thanks to its classic shape. Constructionwise, it is the most versatile version of all GEMINI systems. System profiles can be ordered in welded or punched form. Its features and utility parameters allow for comprehensive and versatile usage with high functionality and aesthetics.

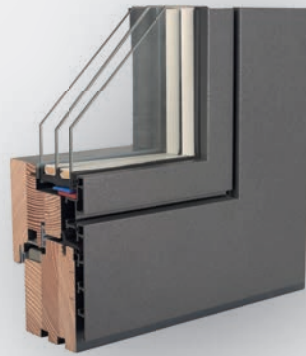
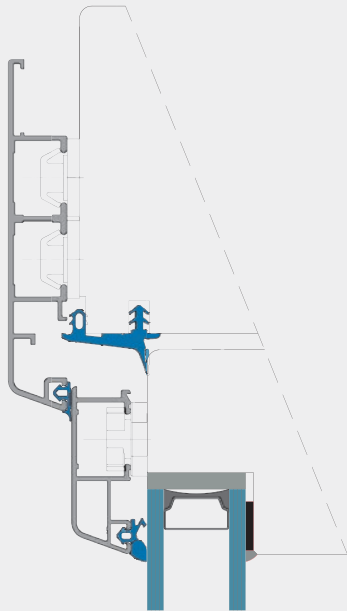

### Gemini Quadrat FB

Systems have distinct profile edges, similar to the Quadrat system. The FB version is distinguished by its flushed sash which visually creates a unified surface. The special shape of the aluminium sash, which shifts the windowpane 15 mm further forward as in more conventional designs, allows for the use of broader glazing with a thinner wood cross-section. Quadrat FB lacks a visible slant and there is a right angle on the surface of its profiles.

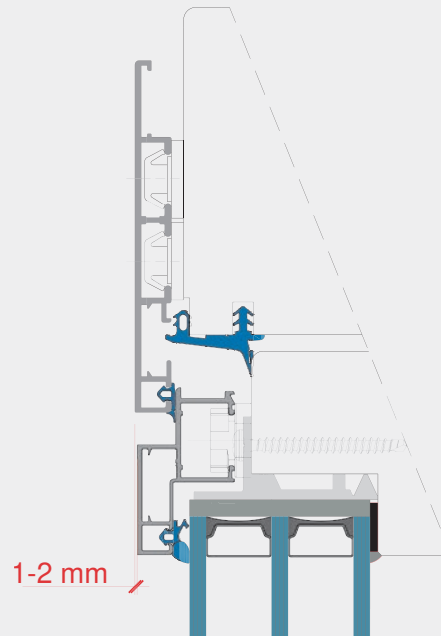

### Gemini Integral

Integral is a unique line of products that belongs to the GEMINI family. It possesses a concealed aluminium sash profile. This creates a visual effect of a single frame, just like in fixed windows. These system profiles were developed without a visible slant and, as a result, create an external right angle. The use of an additional welded gasket in the frame profile increased the overall tightness of the construction which resulted in obtaining the EI 200 classification, approved by IFT Rosenheim tests.

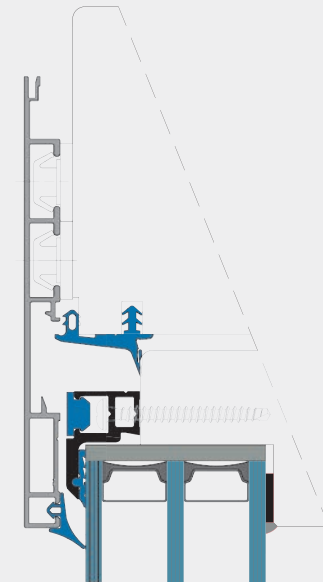





Photo credit: Gretsch-Unitas

**Lift and slide doors** are ideal for living spaces that you want to design in an original way.

This system can be used in both modern and old buildings. With the lift and slide door you can build elegant and comfortable terrace facades. When you open it, you achieve a smooth house-garden combination.

Even older houses can be modernized with little technical, financial expenditure in order to significantly increase living comfort.

The advantage of the system we offer is the possibility of using the sash structure to create a max. width of 3000 mm and max. height of 2700 mm.

The lift and slide fittings used in balcony doors enable us to place the sashes on one level without the need to move the door element outwards.

## PRODUCT DETAILS:

<b>Construction:</b>	<p>profiles: Standard, Standard Plus, Softline, Softline plus, Retro, Retro Plus and wood-aluminium:                      Gemini Linear and Gemini Quadrat,                      - single-frame construction with three-layer glued scantlings (joined along the length),                      - Thickness of the sash: 68mm, 78mm, 92mm,                      - max. width (per element) 3000 mm.</p>
<b>Material:</b>	pine, spruce, larch, meranti, oak + aluminium.
<b>Glazing:</b>	<p>- optional "warm frame" in a colour matched to the colour of the window, safety glass VSG 6-12,                      - anti-burglary: P2 - P5; soundproof panes, solar control, fire protection, Venetian glass, ornamental glass etc.</p>
<b>Fittings:</b>	SIEGENIA/GU.
<b>Way of opening:</b>	Lift&Slide (max. sash weight 500-600 kg).
<b>Colour:</b>	<p>- aluminium color selected from among the color samples on aluminium,                      - wood color: opaque from the RAL palette or azure (showing the wood structure) from the transparent standard colors catalog,                      - three-coat system (opaque color / impregnation, priming, surface) or four-coat system (azure color / impregnation, priming, interlayer, surface).</p>
<b>Warranty:</b>	5 years.

## PATTERNS:

Pattern A



Lift&slide sash	1
max. width	6.700 mm

Pattern C



Lift&slide sash	2
max. width	13.300 mm

Pattern D



Lift&slide sash	2
max. width	6.700 mm

Pattern F

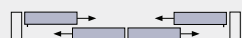

Lift&slide sash	4
max. width	13.300 mm

Pattern G1-asymmetric



Lift&slide sash	1
max. width	9.900 mm

Pattern K

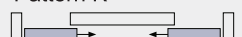

Lift&slide sash	2
max. width	13.300 mm

## WOOD-ALUMINIUM LIFT & SLIDE DOOR

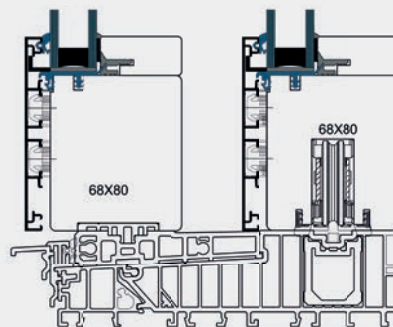
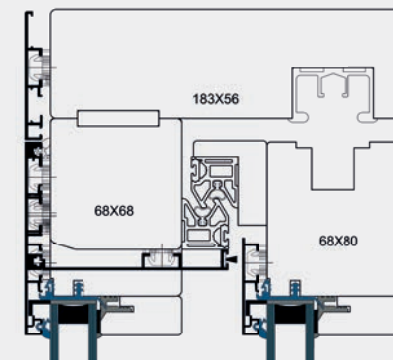

## WOODEN LIFT & SLIDE DOOR

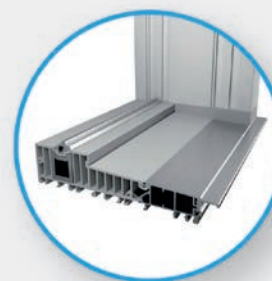
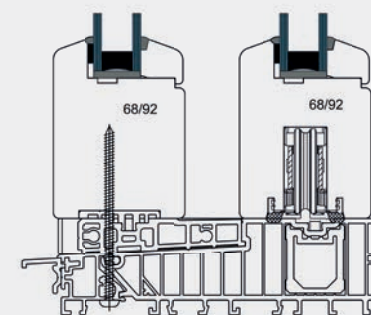
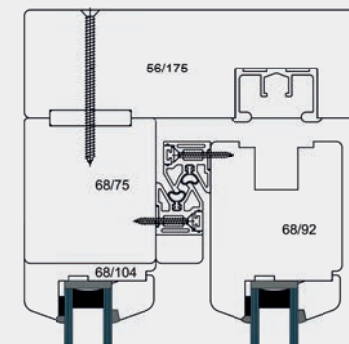

Source: SIEGENIA



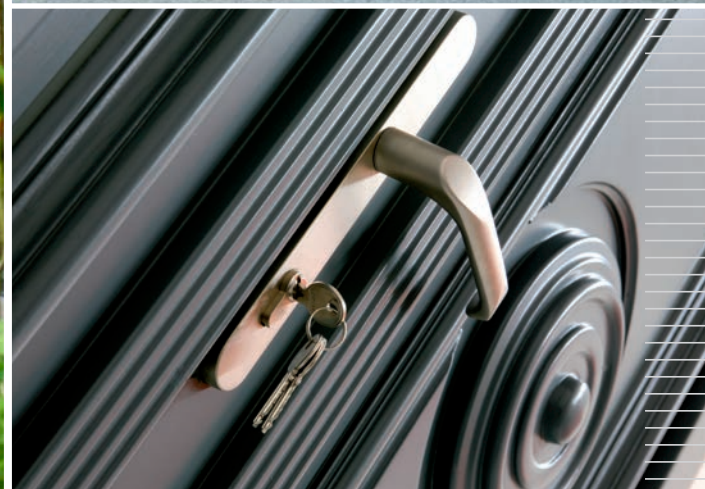

Simple, classic or perhaps richly decorated and in an unusual shape? Historic or traditional? Or maybe burglar-resistant? Everything depends on you.

We offer a wide range of exterior doors and cassette panels that can be perfectly adapted to the windows we produce in terms of material, colour and decorative elements. So that your dream home can deservedly be called beautiful.

The doors are durable, robust, functional and will definitely serve you reliably for a long time. We manufacture doors that are tailored to your individual needs and we are able to meet any requirements in terms of size, shape or style for any door.

We do not manufacture in series production because we want each element to be individual and unique.

## PRODUKTDDETAILS:

<b>Construction:</b>	<ul style="list-style-type: none"> <li>- wooden door frames and doors are 2-fold (profile 68) or 3-fold (profile 78mm or 92mm); width up to 143mm,</li> <li>- Thickness of the frame and sash: 68, 78 or 92mm.</li> <li>- filling (optional): 24 mm up to 48 mm thick VARIOTEC thermal insulation board / glazing,</li> </ul>
<b>Material:</b>	pine, spruce, larch, meranti, oak.
<b>Glazing:</b>	<ul style="list-style-type: none"> <li>- 2-glass package, single-chamber 4/16/4; glazing thermal insulation: <math>U_g = 1.1 \text{ W / m}^2\text{k}</math> (argonfilled inter-pane space) (profile 68),</li> <li>- standard 3-glass package, two-chamber 4/12/4/12/4, glazing thermal insulation: up to <math>U_g=0,6 \text{ W/m}^2</math> (argon-filled inter-pane space) (profile 78),</li> <li>- standard 3-glass package, two-chamber 4/18/4/18/4, glazing thermal insulation: up to <math>U_g=0,5 \text{ W/m}^2</math> (argon-filled inter-pane space) (profile 92),</li> <li>- optional „warm frame“ in a colour matched to the colour of the frame, safety glass VSG 6-12, anti-burglary: P2 - P5; soundproof panes, solar control, fire protection, Venetian glass, ornamental glass etc.</li> </ul>
<b>Fittings:</b>	<ul style="list-style-type: none"> <li>- hinges of the company: GRETSCH-UNITAS (GU) or Carl Fuhr GmbH (FUHR),</li> <li>- optional: the use of the locking mechanisms and hinges in the versions AP, FS for escape doors, anti-panic systems, fire protection and/or smoke protection,</li> <li>- as well as new features of locks with electrical or electronic interlock; locks can be operated with remote control, keyboard, cards or fingerprint readers,</li> <li>- a strip with a three-point locking WINKHAUS, SIMONSWERK BAKA Protect 4000 hinges with adjustment in three planes.</li> </ul>
<b>Threshold:</b>	<ul style="list-style-type: none"> <li>- thermo threshold system of BKV series with the profiles: 70, 80, 90 and 100 mm,</li> <li>- barrier-free aluminium,</li> <li>- optional: drop seal/ sill-free doors.</li> </ul>
<b>Colour:</b>	<ul style="list-style-type: none"> <li>- covering from the RAL palette or azure (showing the structure of the wood) from the catalog of transparent standard colours. Three-layer system / covering colour / impregnation, priming, surface) Four-coat system (azure colour / impregnation, priming, interlayer, surface),</li> <li>- optional: two-colour RAL / azure, azure / RAL</li> </ul>
<b>Silicone:</b>	<ul style="list-style-type: none"> <li>- transparent colour or silicone colour matched to the colour of the door;</li> <li>- available colours: white, cream-white, gray-white, transparent-gray, light-gray, gray, silver-gray, concrete-gray, jasmine, light oak, dark oak, pine brown, ochre brown, medium brown, roe brown, chocolate brown, dark brown, black.</li> </ul>
<b>Handles/Extras:</b>	<ul style="list-style-type: none"> <li>- standard door handles,</li> <li>- knockers,</li> <li>- handles of the producers: HOPPE, FSB and FKS,</li> <li>- additional: thermo-glass, „muntin bars“ (glazing bars),</li> <li>- glass-safety doors, hand-painted doors, moulded parts on request,</li> </ul>
<b>Warranty:</b>	2 years.

## DOOR GLASS HOLDING:

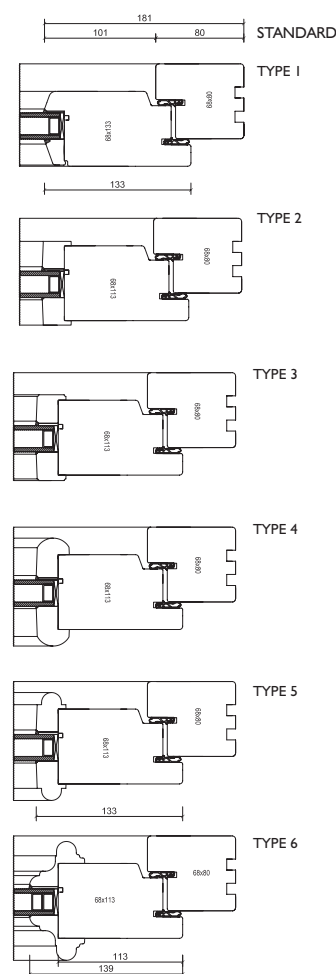

## BKV Eifel threshold systems



## DOOR PROFILES:

### Profile 68

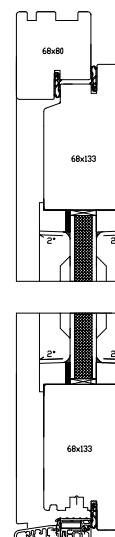

### Profile 78

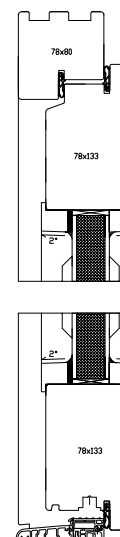

### Profile 92

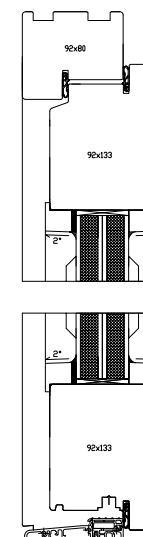

### Panel door

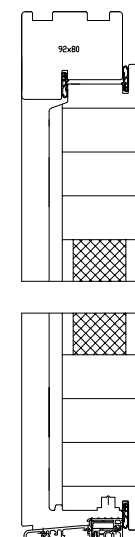

### Standard threshold (a door opening inwards)

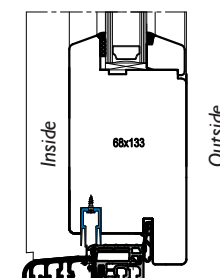

### High threshold (a door opening outwards)

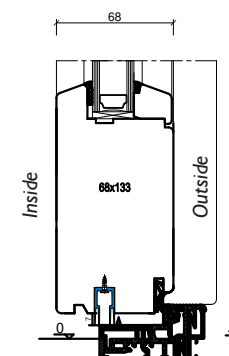





**Winter gardens** open up a new, extraordinary world for us. They are beautiful, practical and offer a wide variety. Winter gardens are a place for rest and relaxation or a cozy get-together at any time of the year.

Winter gardens can be a combination of living space and a green oasis, which are often unique in style and elegance.

The different shapes and constructions can be built in wood or aluminium-wood.

A winter garden unites many advantages:

- it improves the appearance of your home,
- the living comfort is increased,
- you have a better energy balance,
- the humidity in all rooms of the house is stabilized,
- due to the many glass elements in the winter garden, you have a room with a lot of light and brightness.



## TYPES OF GLAZING:



### Double insulation glass

2-glass package, single-chamber  
4/16/4; glazing thermal insulation:  
 $U_g = 1.1 \text{ W / m}^2\text{k}$  (argon-filled inter-pane space),

### Triple Insulation glass

Standard 3-glass package, two-chamber 4/12/4/12/4, glazing thermal insulation: up to  $U_g=0,7 \text{ W/m}^2$  (argon-filled inter-pane space). It is possible to achieve thermal transmittance up to  $0,5 \text{ W/m}^2\text{K}$ .



## The standard quality for glazing is the use of FLOATGLASS.

With standard glazing, the heat transfer coefficient is  $K = 1.1 \text{ W/m}^2\text{K}$  on the inner layer, with invisible noble metal oxides being introduced into the windows to protect against heat loss. The space in between is filled with INERT GAS, with the substances argon or krypton. Due to the excellent insulation values, a triple insulation glazing with a heat transfer coefficient of  $K = 0.5 \text{ W/m}^2\text{K}$  is often used.

We can offer you the following types of glazing:

Neutralux (Heat Insulation), Akustex (Sound Proof), Solarlux (Solar Control), Multipact (Impact Protection), Ardorex (Fire Protection), Dekorex (Light-directing & light-diffusing glass) and Vacurex (Vacuum Heat Insulation) and Ornilux (Bird Protection).

There is also the possibility to use the following glazing:

- P2 – P5 (burglary prevention),
- safety glass VSG6 – 12,
- soundproof panes, solar control, fire protection, Venetian glass, ornamental glass etc.

### Our suppliers for glazing:

**ODERGLAS®**  
EIN TEIL VON UNS.

  
**PRESSGLASS**

 **GLASSOLUTIONS**  
SAINT-GOBAIN



### Spacer - energy saving window with warm edge

They are an excellent alternative to the standard aluminium spacer. Warm Edge inhibits the heat and increases the temperature at the edge of the glass by about 6 degrees Celsius. This counteracts the formation of condensation on the inside. The outside is made of extremely thin stainless steel or aluminium.

The film has very good adhesion. There is a matt surface, without metallic reflexes and reflections.

We offer the following market widths: 12, 14, 15, 20, 22 and 24 mm.

### You can order spacers in the following colours:

- WHITE (RAL 9016)
- LIGHT GRAY (RAL 7035)
- DARK GRAY (RAL 7040)
- BLACK (RAL 9005)
- BROWN (RAL 8003)
- DARK BROWN (RAL 8016)

Our suppliers for thermally insulated frames are the following companies: **TGI, SWISSPACER, CHROMATECH.**



Important note: the shown products and colours may differ from the original.



**ATLANTIC**



**CHINCHILLA**



**CREPI**

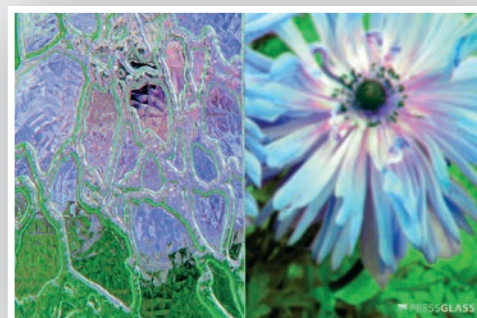

**DELTA**

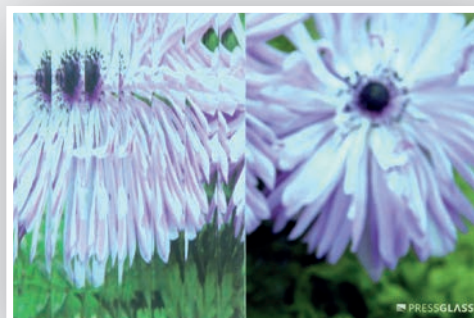

**FLUTES**

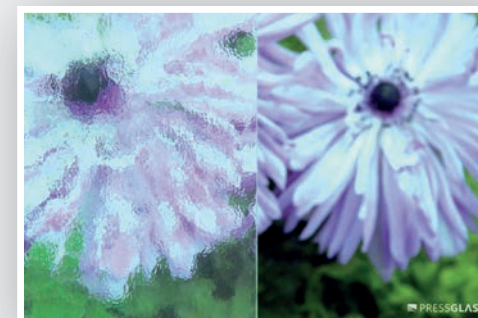

**KATHEDRAL**



**NIAGARA**

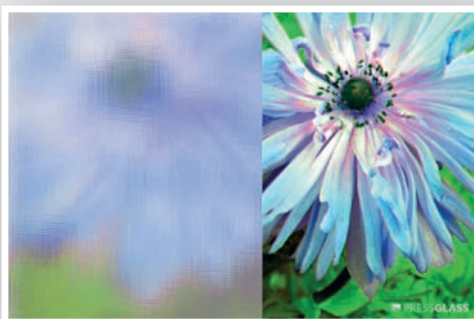

**SCREEN**



**SILVIT**





Window grilles are molded parts for windows or doors and have been used for several hundred years. Today they are used as a decorative element.

These elements beautify buildings, give them their own special look and are eye-catching.

Sash bars offer the possibility of retrofitting windows that have already been individually installed without causing any loss of heat.

By dividing the window with bars, larger window sashes can also be made attractive.



**Glazing bars** - are glued to each side of the pane. A bar is mounted from the inside that imitates a natural division. We offer you separately: Glazing with aluminium frames.

The glazing sash bars are available on individual request. We offer the bars in different sizes and with a bar width of 26 mm or from 20 to 40 mm.

**Sash bars** divide the sash into separate parts with separate discs. Construction bars with 65, 82, 100, 115 and 135 mm are available.

**Retro bars** are characterized by an additional milling and ornaments, so that a window is provided with a historical character.

#### Use of sash bars in windows:

Sash bars are often and primarily used in buildings. For example:

- in new buildings - popular because of their aesthetic advantages and possibilities of dividing the windows,
- where the appearance of windows and facades is to be embellished,
- windows that are part of the building's attractive architecture,
- refurbishment of old buildings - window grilles are a great way to preserve the small partitions of the windows or to install large sashes.

## GLAZING BARS AND SASH BARS

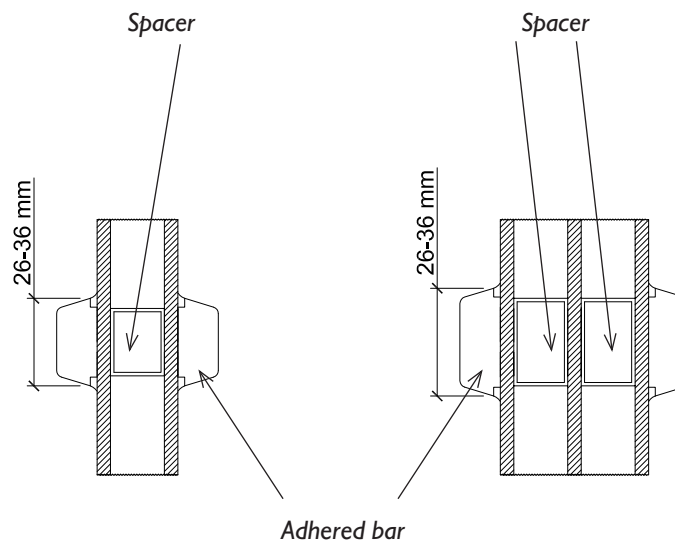

## RETRO BARS

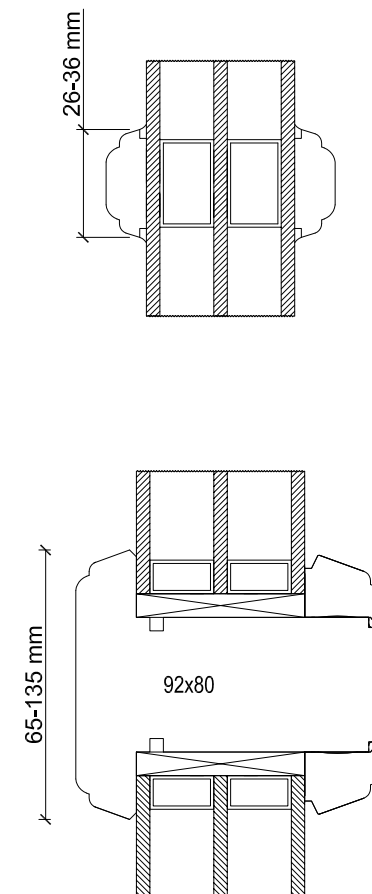



**Drip caps** are a component in the window to catch dripping rainwater and drain it off cleanly.

Our drip edges are made of high quality material. We offer drip caps for our wooden windows in different basic colors, which are matched to the color of the windows.

Our customers like to use drip caps in the wooden drip design. They have a natural look and are easy to set up.

**A wooden shutter** offers optimal protection against external factors such as cold, heat and rain.

Not to be overlooked is the fact that it effectively protects against external noise, and also prevents unauthorised entry or burglary.

Wooden shutters give the building a unique, rustic style. As a result, they constitute a distinctive decorative element of the facade.





Important note: the shown products and colours may differ from the original.

## IN OUR OFFER YOU WILL FIND THE FOLLOWING KINDS OF DRIP CAPS:

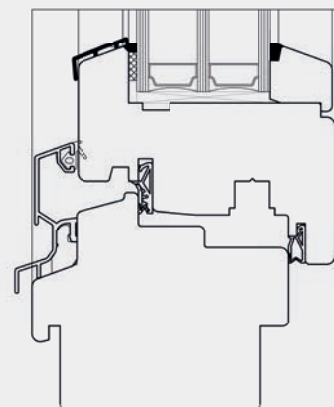

**STANDARD  
ALUMINIUM**

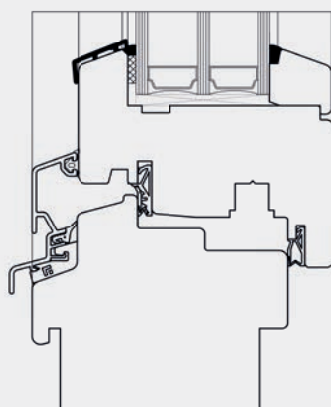

**SPREE D 24 OF**

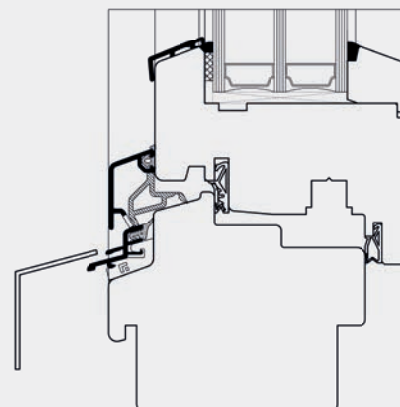

**SPREE 24**

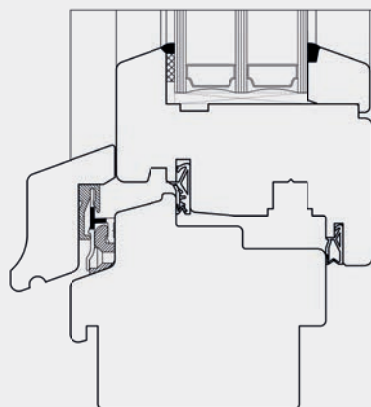

**STIL - VARIANT I**

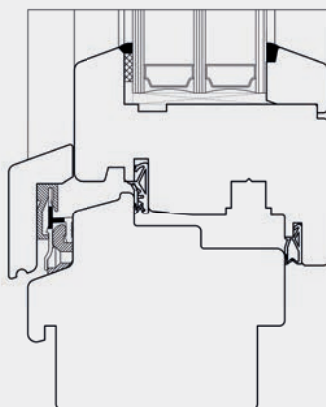

**STIL - VARIANT II**

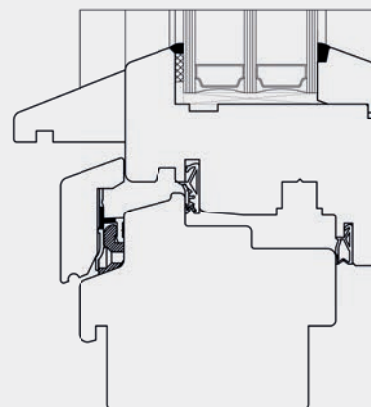

**COMBINATION: WOODEN COVER  
+ WOODEN DRIP CAP  
AT THE SASH**

## COLOURS - EXAMPLES:

(Important note: the following photos show the products with an additional drip cap on the sash (not included in a standard option).)

**WHITE**



**SILVER**



**OLIVE GREEN**



**BROWN**



Our suppliers for drip caps: **GUTMANN** and **ALURON**.

Important note: the shown colours of the products may differ from the original.  
The shown colour samples are not a full offer of wood colours.

## WOOD - PALETTE OF COLOURS - AZURE (EXAMPLES):

	pine wood	meranti wood	oak wood
PINE			
OLD PINE			
CYPRESS			
CHESTNUT			
SAPELLI			
OAK			
WALNUT			
WENGE			

Source: Teknos

## WOOD - PALETTE OF COLOURS - OIL (EXAMPLES):

	701 MATT (spruce wood)		700 PINE SEMI-MATT (spruce wood)
	710 PINE (spruce wood)		702 LARCH (spruce wood)
	903 BASALT GRAY (spruce wood)		707 WALNUT SEMI-MATT (spruce wood)

Source: Osmo

## WOOD - PALETTE OF COLOURS - AZURE (EXAMPLES): for indoor use only

	BIRCH MATT (pine wood)		BADI MATT (pine wood)
	SWISS STONE PINE MATT (pine wood)		CEDAR MATT (pine wood)
	WHITE AZURE MATT (pine wood)		DOUSSIE MATT (pine wood)

Source: Teknos



Important note: the shown colours of the products may differ from the original.  
The shown colour samples are not a full offer of aluminium colours.



**Aluron Color Collection 2 (ACC 2)** is an individual and exclusive palette of colors available only under the **ALURON** brand. It contains over 60 custom, modern and interesting colors that give the windows and buildings a unique character. This wide range of colors gives the opportunity to emphasize the original design, design and aesthetics of the building in the surroundings.

**ACC 2** is a palette of powder-coated colors of various gloss levels, textures and wood-like decors. The collection also includes anodized and anodised imitating colors. Painting in ALURON powder coating facilities is made according to the **QUALICOAT** standard of quality (text source: Aluron).

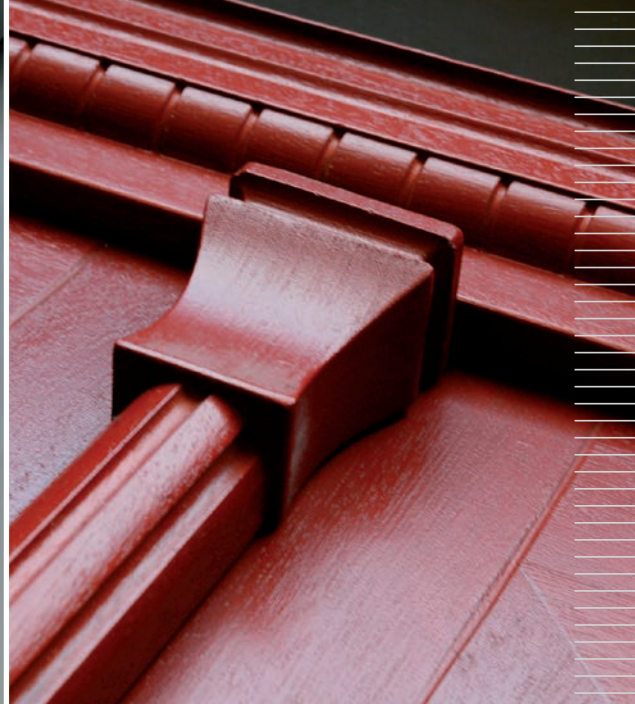

Modern forms, with an aesthetic construction line, the window frame can in itself represent a decoration.

But there are always needs and desires for which we provide our windows with decorative elements that enrich the style of the apartment or building. Or requirements of the monument protection make it necessary to attach ornaments and decorations in order to correspond to the given architectural style.

We are happy to meet your requirements and offer a variety of ornaments and decorations that enrich the appearance of modern and traditional windows.





Important note: the wood samples and colours shown here may differ in the originals.

### HEADBOARD, FOOTBOARD AND ROSETTES - EXAMPLES

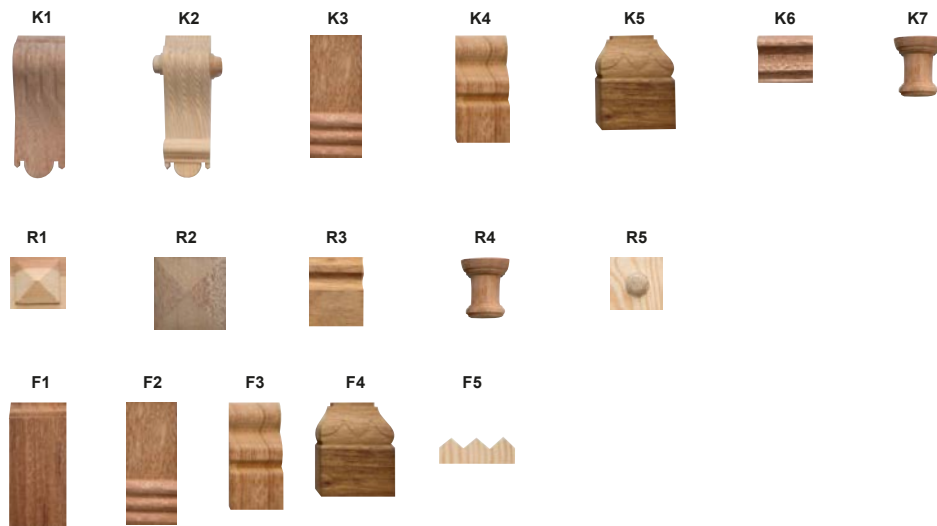

### VERTICAL STRIPS



### HORIZONTAL STRIPS



### CRAFTED CONFIGURATION EXAMPLES







**Exterior roller shutters and external facade blinds** are modern and elegant products which are installed on the outer facade of the building.

We offer you a light and simple design, ideal for modern and architectural buildings, with small or large glass surfaces.

These products are suitable for windows made of wood and wood-aluminium.



### Exterior shutters

Our modern products are easy to install and adapt to any facade. Exterior roller shutters have a number of advantages, including:

- insulation of heat and sound,
- protection against burglary,
- offering privacy,
- offering protection against the sun and insects.

Our products are adapted to the highest requirements and every building situation. Exterior roller shutters are offered in a wide range of colors and architectural solutions, always in accordance with the individual project.

### External facade blinds

External facade blinds protect the inside of the building from excessive solar radiation, noise, heat and environmental influences and always improve the external appearance of an object.

The use of blinds offers considerable savings in energy consumption and improves the possibilities of optimal air conditioning in the rooms according to the seasons.

On large facades, they are an additional insulation that also affects the temperature distribution in the room and often also helps not to burden the air conditioning.

### ROLLER SHUTTERS

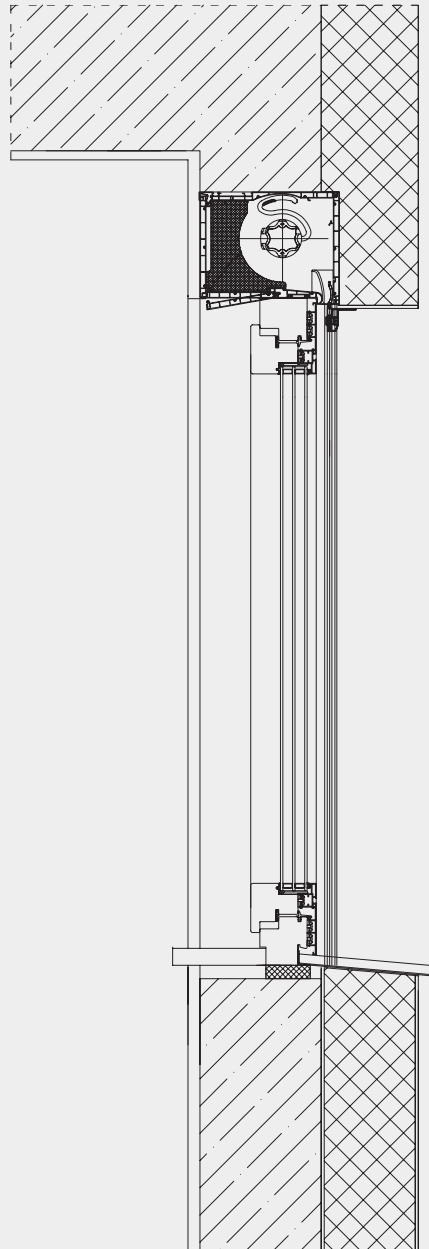

### EXTERNAL FACADE BLINDS

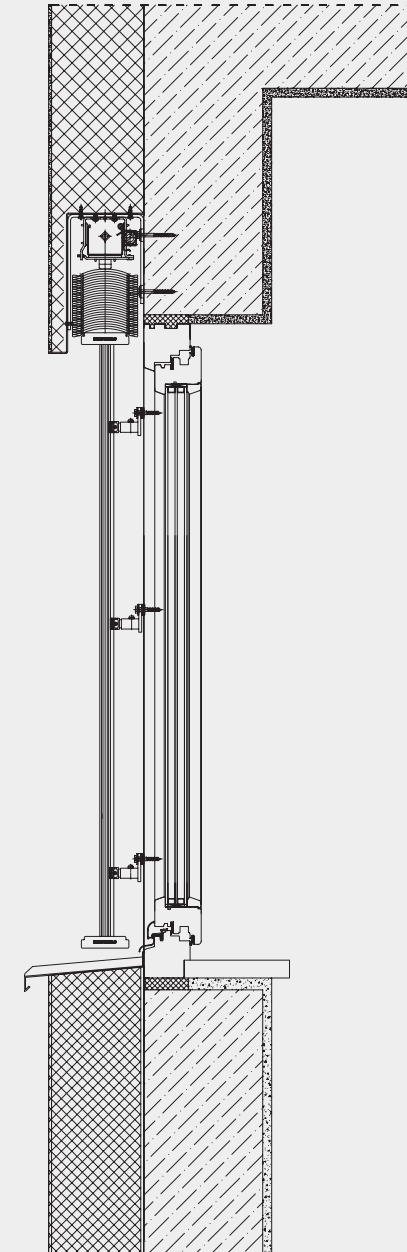

Our suppliers for roller shutters and blinds: **WAREMA** and **ANWIS**.



Standard equipment, protection or equipment in the old style, we offer you:

- handles with simple shapes,
- handles for standard windows,
- handles for doors and windows with anti-burglary devices,
- door handles that offer safe child protection,
- customized handles,
- door knockers,
- protection rosettes in different colours.

In our catalogue you can choose from our various range of handles.



Source: HOPPE

